



600-1-33SD16  
(M55302/6-04)



ST600-1-33P1  
(M55302/5-04)

33 CONTACTS



600-1-41SD16  
(M55302/6-05)



ST600-1-41P  
(M55302/5-05)

41 CONTACTS

# SERIES **ST600-1** MICRO-MINIATURE STRAIGHT-THRU MOUNTING **PRINTED CIRCUIT PIN CONNECTORS** FLOW SOLDER TERMINATIONS

**MEETS MIL-C-55302/5**

**.100" (2.54MM) CONTACT SPACING**  
**2 ROWS OFFSET .050 (1.27MM)**  
**.100" (2.54MM) ROW SPACING**

**9, 17, 25, 33, 41 & 77 CONTACTS**

# SERIES ST600-1 PRINTED CIRCUIT CONNECTORS

9, 17, 25, 33, 41 & 77 CONTACTS

**.100" (2.54MM) CONTACT SPACING**  
**2 ROWS OFFSET .050 (1.27MM)**  
**.100" (2.54MM) ROW SPACING**

**MEETS MIL-C-55302/5**

**REFER TO PAGE 6  
FOR MATING RECEPTACLE**  
**600-1-( )SD11 OR**  
**600-1-( )SD16**

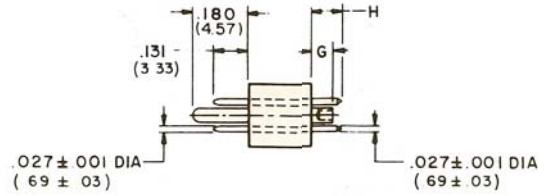

33 CONTACTS

ST600-1-33P1  
(M55302/5-04)



41 CONTACTS

ST600-1-41P1  
(M55302/5-05)

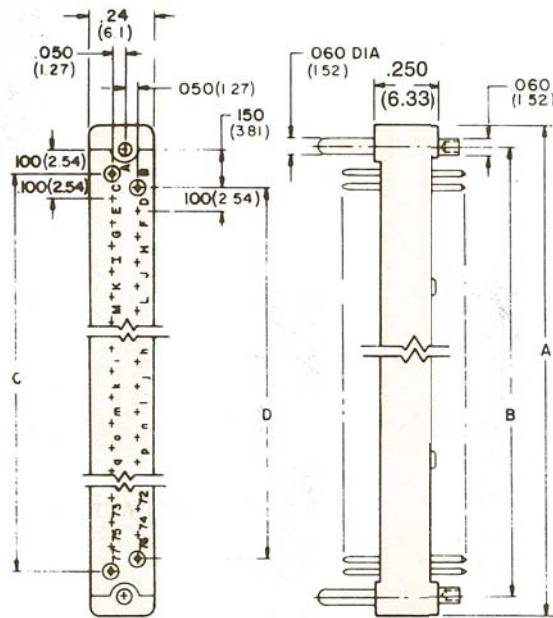

PLUG  
MEETS MIL-C-55302/5

PART NO.	G	H
ST600-1-( ) P	.090 (2.29)	.110 (2.79)
ST600-1-( ) P1	.128 (3.25)	.164 (4.17)
ST600-1-( ) P2	.090 (2.29)	.164 (4.17)

M55302/5-01 THRU -06

↑ ENTER NO. OF CONTACTS  
(9, 17, 25, 33, 41 or 77)

NO. OF CONTACTS	DIMENSIONS			
	A	B	C	D
9	.75 (19.1)	.600 (15.24)	.400 (10.16)	.300 (7.62)
17	1.15 (29.2)	1.000 (25.40)	.800 (20.32)	.700 (17.78)
25	1.55 (39.4)	1.400 (35.56)	1.200 (30.48)	1.100 (27.94)
33	1.95 (49.5)	1.800 (45.72)	1.600 (40.64)	1.500 (38.10)
41	2.35 (59.7)	2.200 (55.88)	2.000 (50.80)	1.900 (48.26)
77	4.15 (105.4)	4.000 (101.60)	3.800 (96.52)	3.700 (93.98)

DIMENSIONS IN PARENTHESES ARE IN MILLIMETERS