

DWG. NO.		220-510-0008G	
REV	DESCRIPTION	BY	DATE
A	ECN 2364	JHM	7/27/00

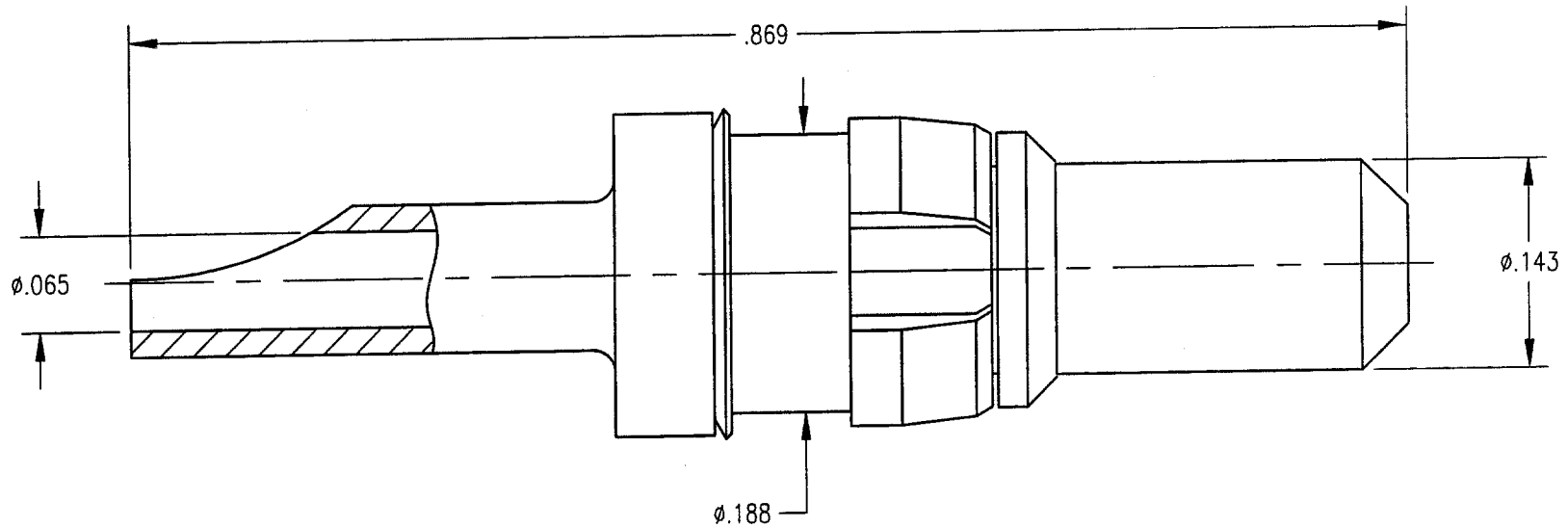

NOTES:

- MATERIALS:  
 BODY: BRASS PER ASTM B16  
 CLIP RING: BERYLLIUM COPPER PER ASTM B194
- FINISH:  
 BODY: .000030 MIN. GOLD PER MIL-G-45204 OVER  
 .000050 MIN. NICKEL PER QQ-N-290  
 CLIP RING: .000005 MIN. GOLD PER MIL-G-45204 OVER  
 .000050 MIN. NICKEL PER QQ-N-290
- ELECTRICAL:  
 CURRENT RATING: 10 AMPS MIN.

PER ASME Y14.5M-1994 UNLESS OTHERWISE SPECIFIED: DIMENSIONS ARE IN INCHES (MM)		<b>Litton</b>	
TOLERANCES: DECIMALS .XX ± .01/0.254 XXX ± .005/0.127 ANGLES ± 2°		Winchester/Retconn 400 Park Road Watertown, Connecticut 06795	
SCALE: 8:1		TITLE	
<b>CUSTOMER DRAWING</b>		RDM PLUG, HIGH POWER	
DRAWN JED	DATE 4/21/97	CHECKED JMC	DATE 4/21/97
APPROVED AT	DATE 4/21/97	APPROVED AT	DATE 4/21/97
A		220-510-0008G	SHT. OF REV. 1 1 A